



120 Eastgate Drive SE
Hutchinson, MN 55350

1-888-321-6789
www.caproskis.com

SKI INSTALLATION INSTRUCTIONS

SKI-DOO 2000 & NEWER
ADSA, REV/XP/XM/XS
ALL MODELS 2000 & NEWER EXCEPT TUNDRA & SKANDIC
MOUNTING KIT #76000325

1. Remove old ski.
2. Discard unneeded hardware.
3. Install carbide on ski using the manufacturers guidelines & hardware.
4. Place the two spools (top hat shaped) into the inner saddle of the ski and push outward until flush in the saddles, they will fit very tightly. (see Figure 1)
5. Place the rubber dampener in the ski. (see Figure 2 for dampener orientation)
6. Recommend greasing spindle bolt.
7. Using remaining hardware, secure ski to snowmobile. (see diagram)
8. Repeat steps 1-7 for other ski.

| ITEM # | PART # | DESCRIPTION | QTY |
|--------|----------|---------------------------------|-----|
| 1 | 76000219 | WASHER, 1.5" X .406" X .187" | 4 |
| 2 | 76000246 | BUSHING 10MM | 4 |
| 3 | 76000190 | METRIC BOLT, 10-1.5 X 130MM HEX | 2 |
| 4 | 76000193 | METRIC NUT, M10-1.5 NYLOC | 2 |
| 5 | 77000271 | DAMPENER - 271 | 2 |
| 6 | 00251 | WASHER, 7/16" FLAT SAE | 4 |

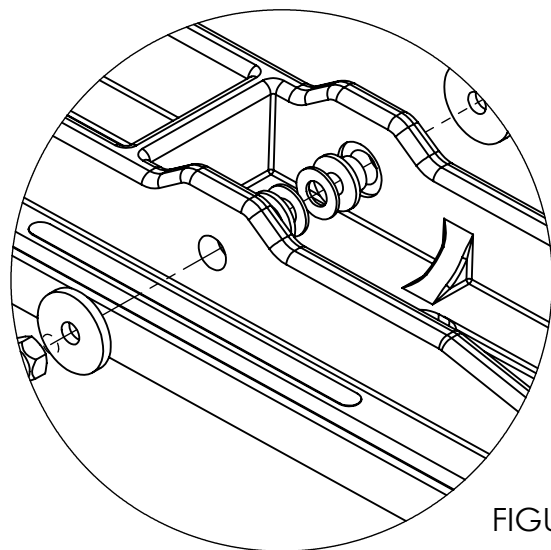
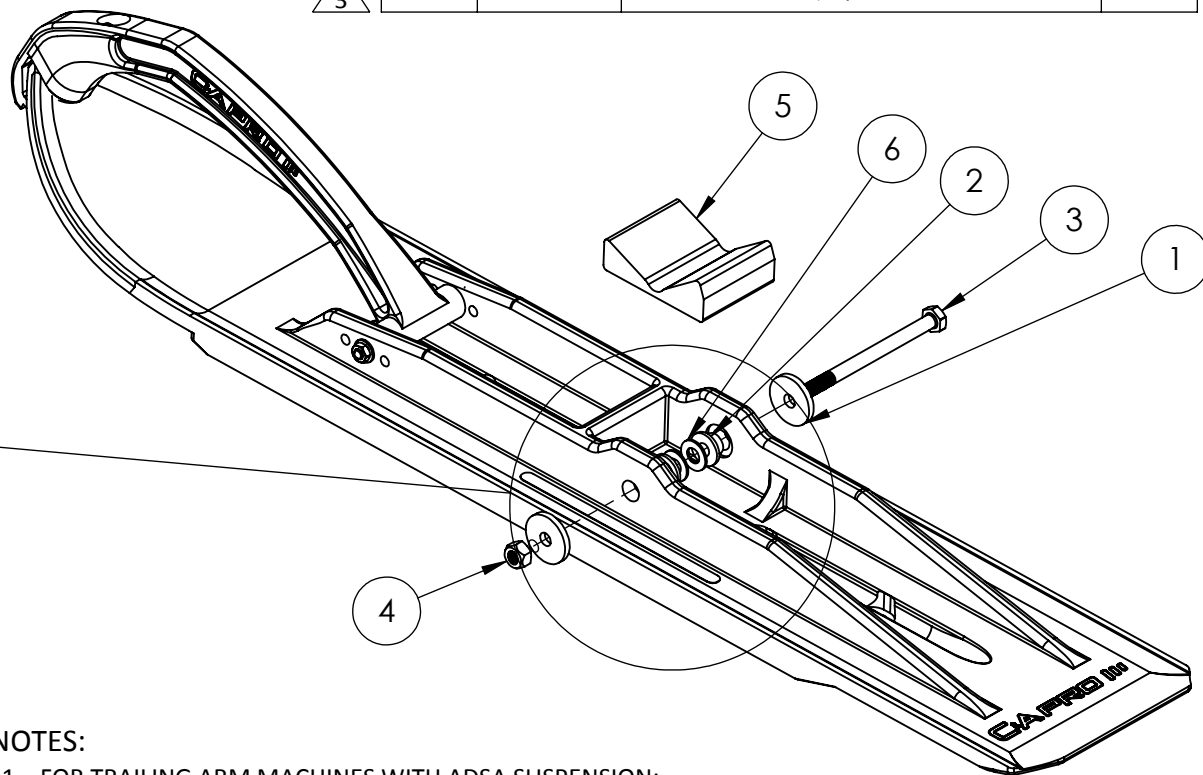

FIGURE 1



NOTE:

BY DESIGN, THE SKIS ARE MORE AGGRESSIVE THAN FACTORY STANDARD SKIS. IF FOR TRAIL RIDING YOU FIND THAT THE SKIS ARE TURNING TO HARD, YOU MAY WANT TO LIGHTEN SKI PRESSURE FOR EASIER TURNING. FOR ASSISTANCE ON LIGHTENING SKI PRESSURE, CONSULT YOUR SNOWMOBILE OWNERS MANUAL OR YOUR SNOWMOBILE DEALER.

NOTES:

1. FOR TRAILING ARM MACHINES WITH ADSA SUSPENSION: REUSE OF OEM DAMPENER IS REQUIRED.
2. 2016 & NEWER MACHINES WITH ADJUSTABLE T.S. SKIS: REQUIRED TO PURCHASE SKI-DOO #505073779 (QTY.2)



7/16" Washer not utilized on select machines.